

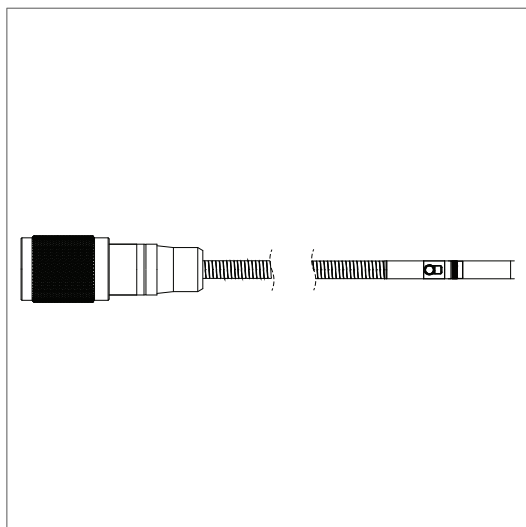

User Manual

VS80 Dual HD Camera Probe

MODEL VS80C2HD-49-3RM



Introduction

This probe is designed for use with the VS80 High Performance Videoscope. The probe is controlled by the touch-screen icons and control buttons on the VS80.

The VS80 user manual and additional translations of this probe manual are available from the support site (see the Support section).

Please update the VS80 firmware before use, as explained in the VS80 manual. This will ensure optimal functionality and full compatibility with your camera probe.

Product Descriptions

The VS80 Videoscope offers many useful and convenient features including capturing still images and video, changing camera views, connecting with mobile devices, and controlling worklights. Please refer to the VS80 user manual for complete information.

The probe head is 4.9 mm in diameter and its probe length is 9.8 ft. (3 m). The camera resolution is 1280 x 720.

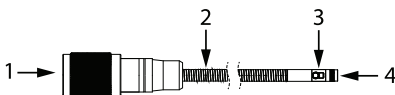

1. VS80 connector
2. Probe
3. Side view camera and worklights
4. Forward view camera

Connecting the Probe

The steps, below, explain how to safely connect the probe to the VS80 monitor. Always switch OFF the VS80 before replacing the probe.

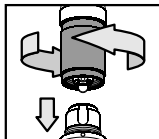

1. Align the white dot on the probe connector with the white dot on the monitor connector.
2. Plug the probe into the monitor unit, ensuring proper alignment and full insertion.
3. Tighten the collar nut to secure the connection. Do not overtighten.

Centering Ball Accessory

The centering ball accessory guides the probe safely through the area under test, keeping the camera tip centered. Follow the steps below to attach the accessory.

- | |
|---|
| 1. Remove the protective cap from the camera tip. |
|---|

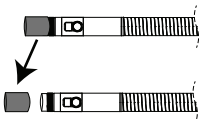

- | |
|---|
| 2. Slide the centering ball assembly onto the camera probe. |
|---|

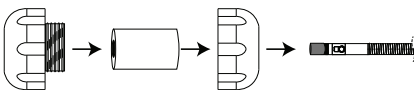

- | |
|---|
| 3. Assemble the three sections and tighten. |
|---|

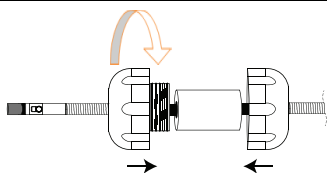

4. Keep a safe distance between the centering ball and the camera tip to prevent pressure damage.

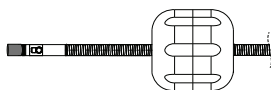

5. Attach the protective cap and tighten the protection ring.

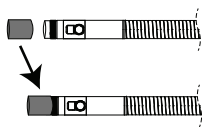

Safety

Please read and understand all safety cautions before use.



⚠ CAUTION

Do not insert the probe into flammable liquid or gas.

This product is designed for industrial use only. It is not intended for use in human or other biological inspection.

Do not disassemble the product, damage to the product and electrical shock may occur.

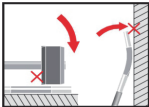
Avoid direct sun exposure. Store in a cool, dry, and well-ventilated area.

	<p>The probe contains sensitive circuitry that controls the optics and electronics of the camera. Do not strike the probe or allow it to impact objects forcefully.</p>
	<p>Immerse probes only in approved liquids (see the Specifications section).</p>

Cleaning

To clean the probe, wipe with a soft cloth dampened with a mild detergent and clean water. Do not use abrasives, corrosives (alcohol), or solvents to clean the probe. Use a high quality lens cleaning fluid and a lint-free swab to clean the camera and worklight lenses.

Specifications

Camera resolution	1280 (H) x 720 (V)
Frame rate	30 frames per second (fps), approximately
Probe Diameter	4.9 mm
Field of View	90°
Depth of Field	0.4 to 4.0 in. (10 to 100 mm)
Probe tip length	0.86 in. (21.8 mm)
Probe length	9.8 ft. (3 m)
Side-view camera	Yes
LED Worklights	Worklights are controlled from the VS80. Five (5) forward and one (1) side worklight
Operating temperature	32 to 140°F (0 to 60°C)
Storage temperature	-4 to 140°F (-20 to 60°C)
Relative Humidity	10 to 95 % non-condensing

Approved liquids for digital camera probes	Approved for use in brake and transmission fluid, diesel fuel, unleaded gasoline, engine oil, and CPC hydraulic fluid (46AWS).
Ingress rating	Probe tip and body: IP 67 (IEC 60529) Protected from submersion in water up to 3.3 ft. (1 m) for 30 minutes maximum.

Warranty and Support

Limited 3-Year Warranty

This product is protected by FLIR's Limited 3-Year Warranty. Visit www.flir.com/testwarranty to read the warranty document.

CUSTOMER SUPPORT

Customer Support Telephone List	https://support.flir.com/contact
Repair, Calibration, and Technical Support	https://support.flir.com

Website

<http://www.flir.com>

Customer support

<http://support.flir.com>

Copyright

© 2025, FLIR Systems, Inc. All rights reserved worldwide.

Disclaimer

Specifications subject to change without further notice. Models and accessories subject to regional market considerations. License procedures may apply. Products described herein may be subject to US Export Regulations. Please refer to exportquestions@flir.com with any questions.

Publ. No.: NAS100222
Release: AB
Commit: 105311
Head: 105321
Language: en-US
Modified: 2025-05-29
Formatted: 2025-05-29

